

V Aleji x Božkova x Ciolkovského x Školská(1:700) - Klad listů (1:2231)

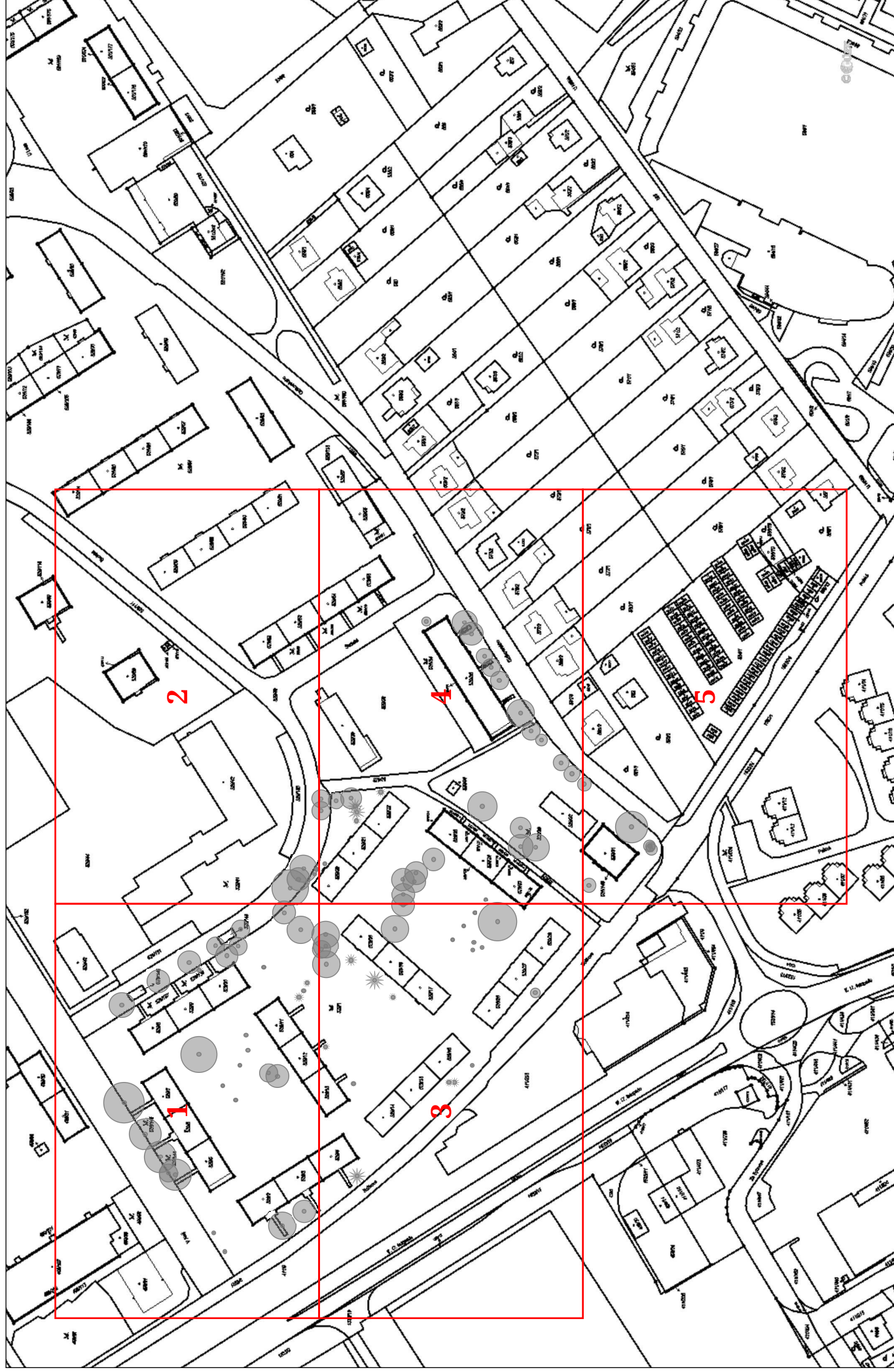

V Aleji x Božkova x Ciolkovského x Školská(1:700), 2/5

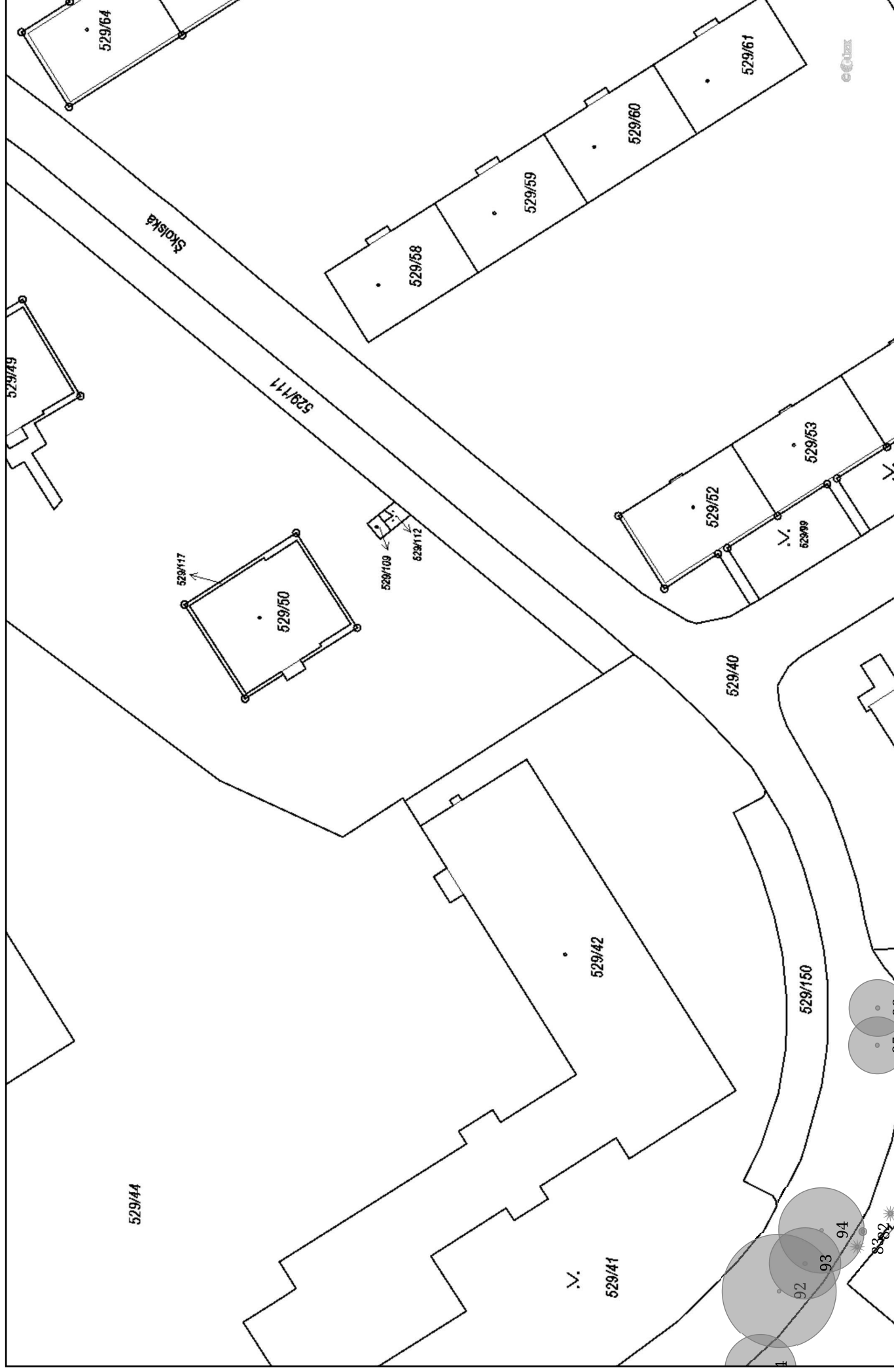

V Aleji x Božkova x Ciolkovského x Školská(1:700), 3/5

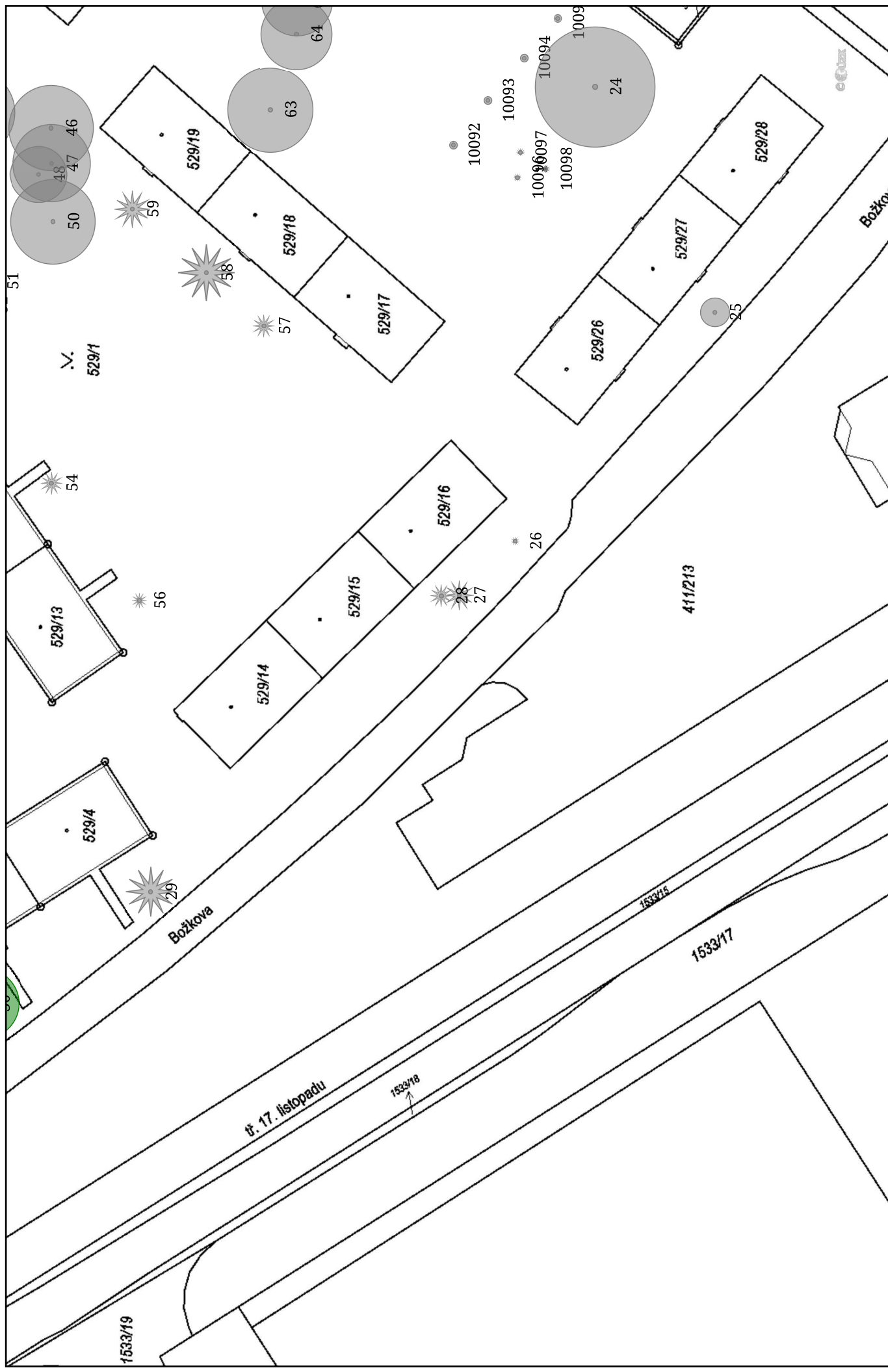

V Aleji x Ciolkovského x U Lesa(1:700) - Klad listů (1:2975)

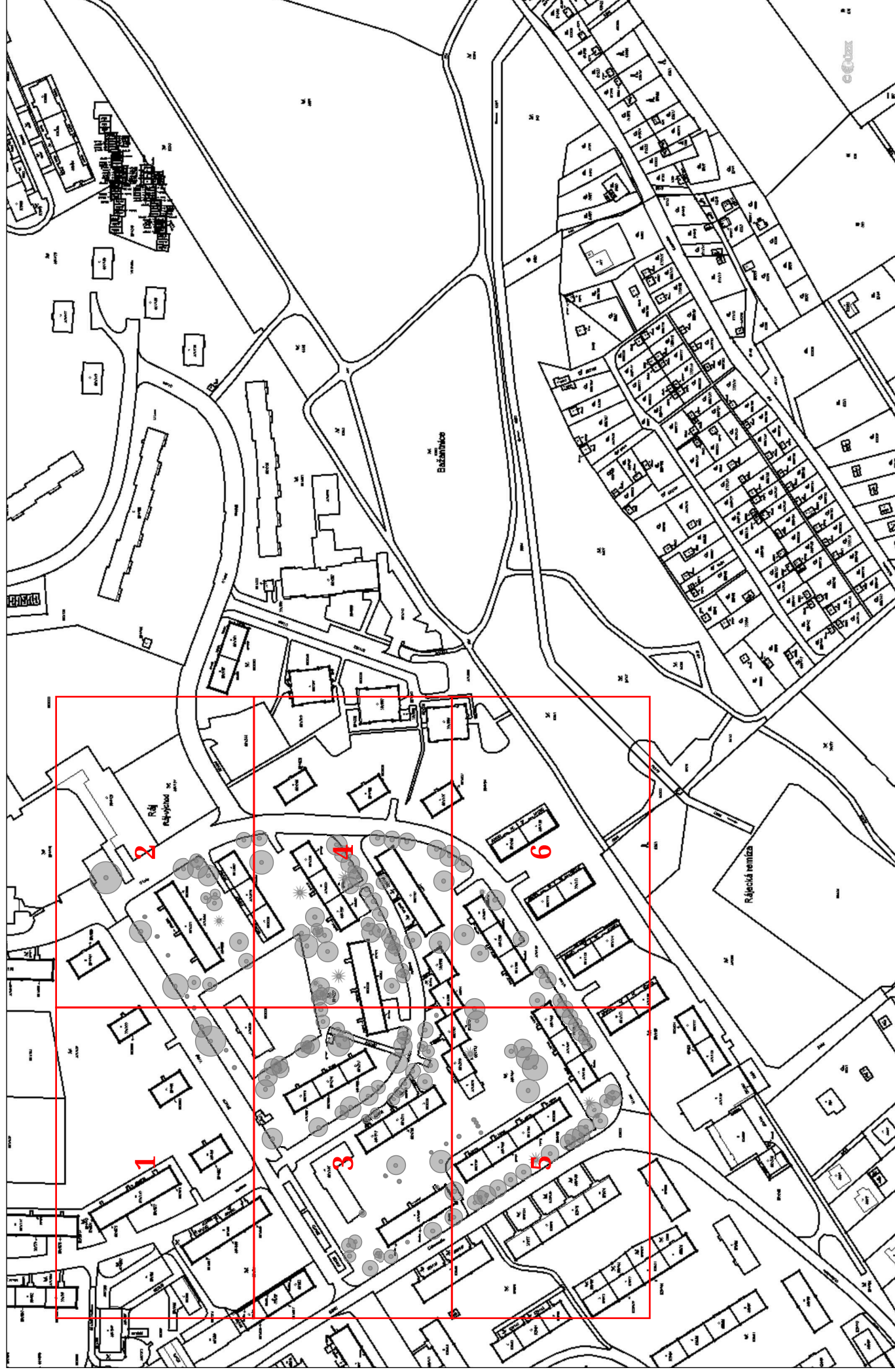

V Aleji x Ciolkovského x U Lesa(1:700), 1/6



V Aleji x Ciolkovského x U Lesa(1:700), 4/6



This is a detailed cadastral map of a residential area in Berlin. The map shows several large buildings with multiple lots, smaller structures, and numerous trees represented by circles. Lot numbers are clearly marked on the buildings and along the streets. Street names like 'U. Lehn' and '535/1' are visible. The map is oriented with North at the top.

Key Features:

- Buildings and Lots:**
 - Top left: Building with lots 501/334 and 501/627.
 - Top center: Building with lots 501/164, 501/381, 501/168, 501/380, and 501/169.
 - Center: Building with lots 501/379, 501/170, 501/378, and 501/171.
 - Bottom center: Building with lots 501/422, 501/172, 501/173, 501/423, and 501/174.
 - Bottom right: Building with lots 501/424, 501/175, 501/425, and 501/176.
 - Left side: Building with lots 501/206, 501/1716, 501/173, 501/201, 501/200, 501/1731, 501/199, 501/184, 501/1726, 501/171, 501/172, 501/173, 501/174, 501/175, 501/176, 501/177, 501/178, 501/179, 501/180, 501/181, 501/182, 501/183, 501/184, 501/185, 501/186, 501/187, 501/188, 501/189, 501/190, 501/191, 501/192, 501/193, 501/194, 501/195, 501/196, 501/197, 501/198, 501/199, 501/200, 501/201, 501/202, 501/203, 501/204, 501/205, 501/206, 501/207, 501/208, 501/209, 501/210, 501/211, 501/212, 501/213, 501/214, 501/215, 501/216, 501/217, 501/218, 501/219, 501/220, 501/221, 501/222, 501/223, 501/224, 501/225, 501/226, 501/227, 501/228, 501/229, 501/230, 501/231, 501/232, 501/233, 501/234, 501/235, 501/236, 501/237, 501/238, 501/239, 501/240, 501/241, 501/242, 501/243, 501/244, 501/245, 501/246, 501/247, 501/248, 501/249, 501/250, 501/251, 501/252, 501/253, 501/254, 501/255, 501/256, 501/257, 501/258, 501/259, 501/260, 501/261, 501/262, 501/263, 501/264, 501/265, 501/266, 501/267, 501/268, 501/269, 501/270, 501/271, 501/272, 501/273, 501/274, 501/275, 501/276, 501/277, 501/278, 501/279, 501/280, 501/281, 501/282, 501/283, 501/284, 501/285, 501/286, 501/287, 501/288, 501/289, 501/290, 501/291, 501/292, 501/293, 501/294, 501/295, 501/296, 501/297, 501/298, 501/299, 501/300, 501/301, 501/302, 501/303, 501/304, 501/305, 501/306, 501/307, 501/308, 501/309, 501/310, 501/311, 501/312, 501/313, 501/314, 501/315, 501/316, 501/317, 501/318, 501/319, 501/320, 501/321, 501/322, 501/323, 501/324, 501/325, 501/326, 501/327, 501/328, 501/329, 501/330, 501/331, 501/332, 501/333, 501/334, 501/335, 501/336, 501/337, 501/338, 501/339, 501/340, 501/341, 501/342, 501/343, 501/344, 501/345, 501/346, 501/347, 501/348, 501/349, 501/350, 501/351, 501/352, 501/353, 501/354, 501/355, 501/356, 501/357, 501/358, 501/359, 501/360, 501/361, 501/362, 501/363, 501/364, 501/365, 501/366, 501/367, 501/368, 501/369, 501/370, 501/371, 501/372, 501/373, 501/374, 501/375, 501/376, 501/377, 501/378, 501/379, 501/380, 501/381, 501/382, 501/383, 501/384, 501/385, 501/386, 501/387, 501/388, 501/389, 501/390, 501/391, 501/392, 501/393, 501/394, 501/395, 501/396, 501/397, 501/398, 501/399, 501/400, 501/401, 501/402, 501/403, 501/404, 501/405, 501/406, 501/407, 501/408, 501/409, 501/410, 501/411, 501/412, 501/413, 501/414, 501/415, 501/416, 501/417, 501/418, 501/419, 501/420, 501/421, 501/422, 501/423, 501/424, 501/425, 501/426, 501/427, 501/428, 501/429, 501/430, 501/431, 501/432, 501/433, 501/434, 501/435, 501/436, 501/437, 501/438, 501/439, 501/440, 501/441, 501/442, 501/443, 501/444, 501/445, 501/446, 501/447, 501/448, 501/449, 501/450, 501/451, 501/452, 501/453, 501/454, 501/455, 501/456, 501/457, 501/458, 501/459, 501/460, 501/461, 501/462, 501/463, 501/464, 501/465, 501/466, 501/467, 501/468, 501/469, 501/470, 501/471, 501/472, 501/473, 501/474, 501/475, 501/476, 501/477, 501/478, 501/479, 501/480, 501/481, 501/482, 501/483, 501/484, 501/485, 501/486, 501/487, 501/488, 501/489, 501/490, 501/491, 501/492, 501/493, 501/494, 501/495, 501/496, 501/497, 501/498, 501/499, 501/500, 501/501, 501/502, 501/503, 501/504, 501/505, 501/506, 501/507, 501/508, 501/509, 501/510, 501/511, 501/512, 501/513, 501/514, 501/515, 501/516, 501/517, 501/518, 501/519, 501/520, 501/521, 501/522, 501/523, 501/524, 501/525, 501/526, 501/527, 501/528, 501/529, 501/530, 501/531, 501/532, 501/533, 501/534, 501/535, 501/536, 501/537, 501/538, 501/539, 501/540, 501/541, 501/542, 501/543, 501/544, 501/545, 501/546, 501/547, 501/548, 501/549, 501/550, 501/551, 501/552, 501/553, 501/554, 501/555, 501/556, 501/557, 501/558, 501/559, 501/560, 501/561, 501/562, 501/563, 501/564, 501/565, 501/566

V Aleji x Školská x Ciolkovského(1:700) - Klad listů (1:2975)

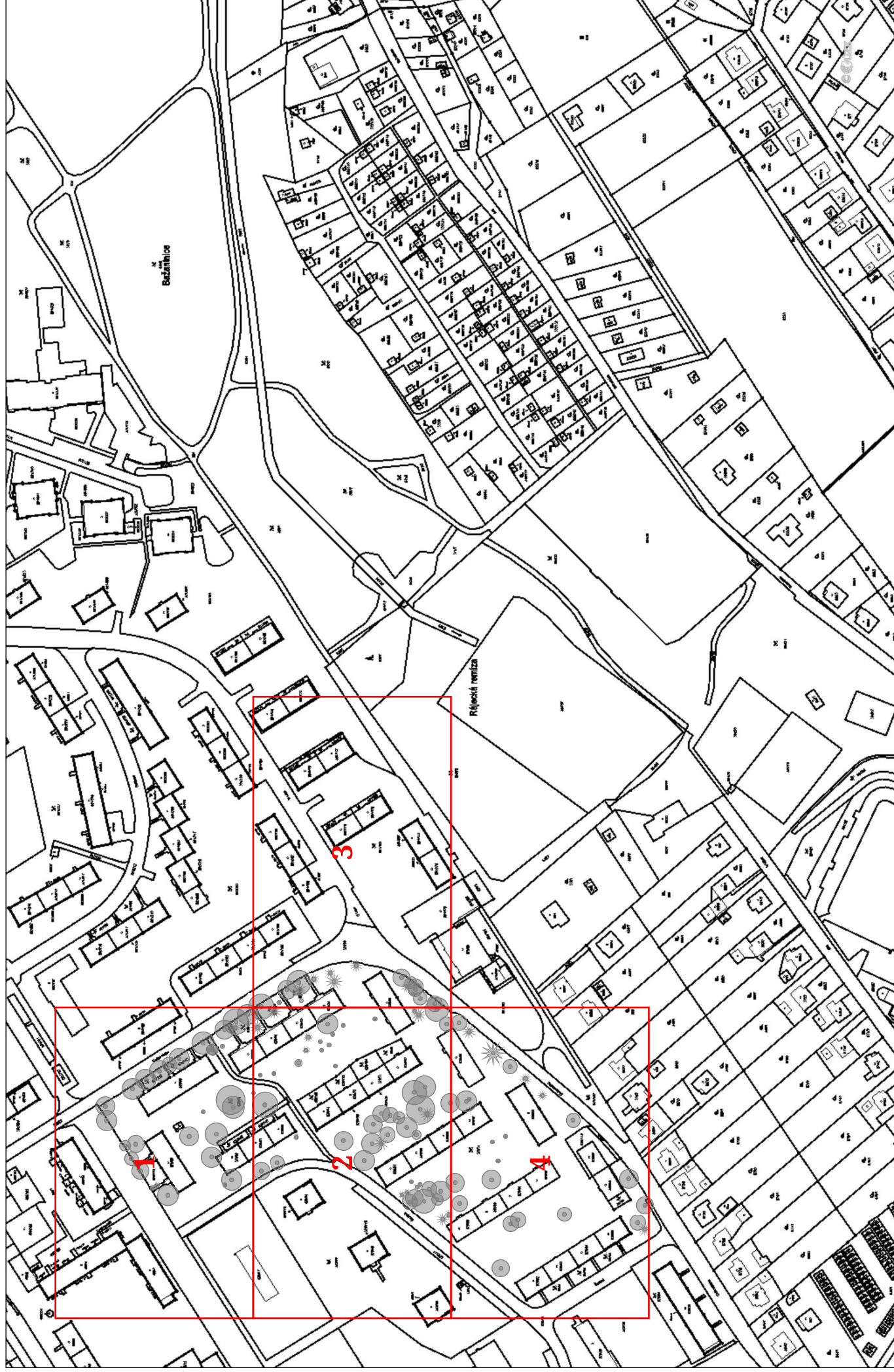

V Aleji x Školská x Ciolkovského(1:700), 1/4



V Aleji x Školská x Ciolkovského(1:700), 2/4

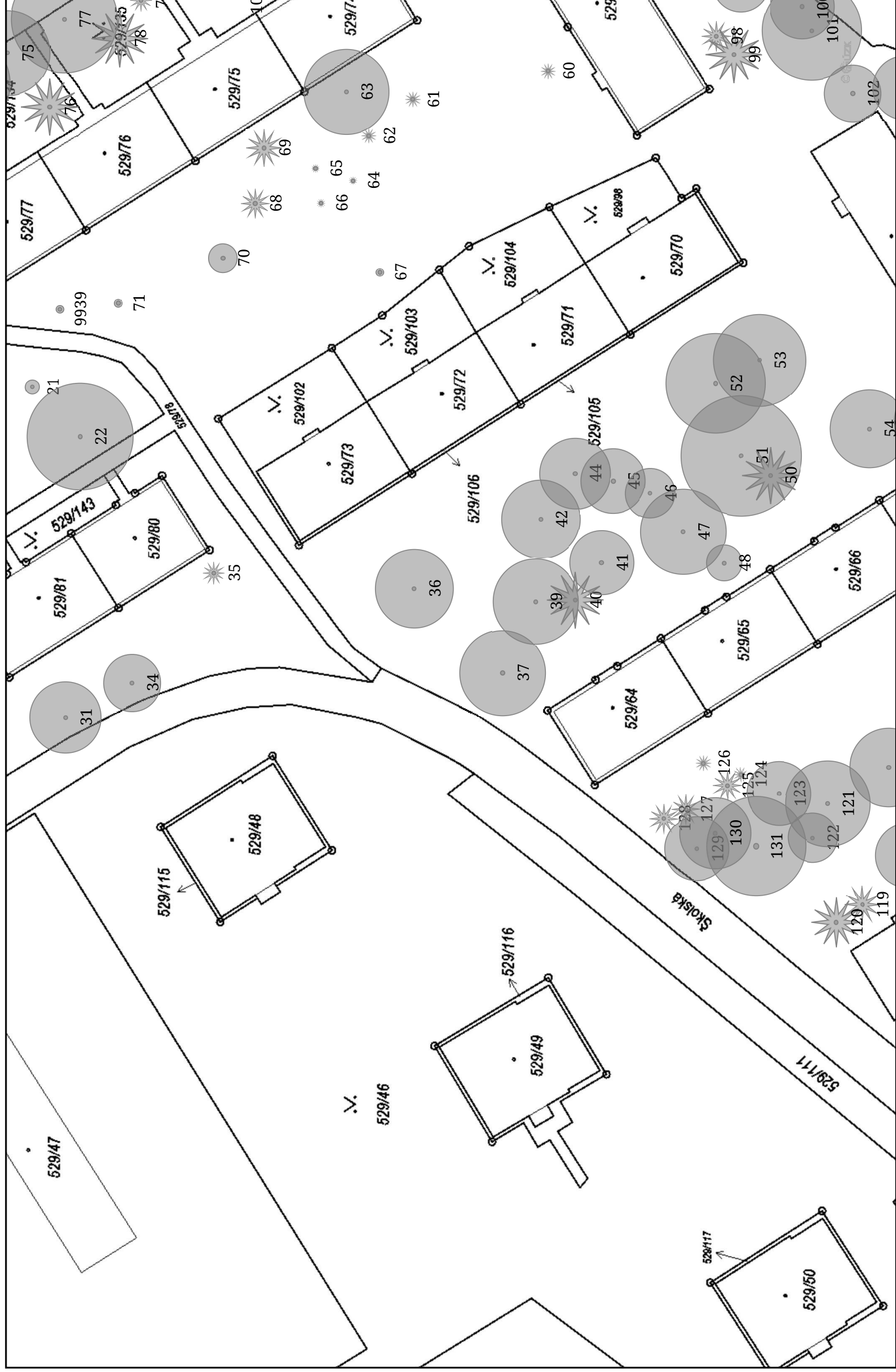

V Aleji x Školská x Ciolkovského(1:700), 4/4



V Aleji(1:700) - Klad listů (1:2975)

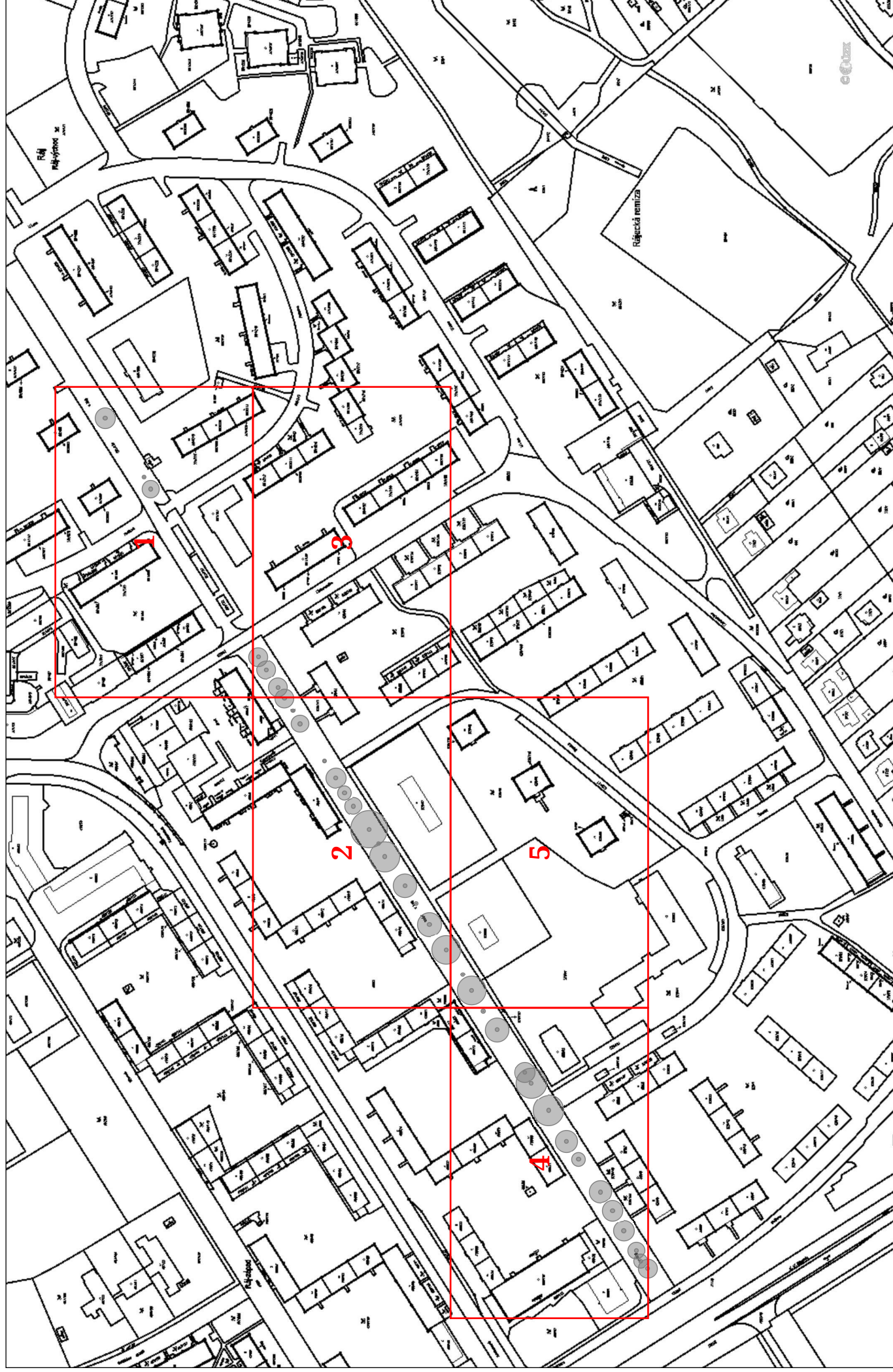

V Aleji(1:700), 2/5

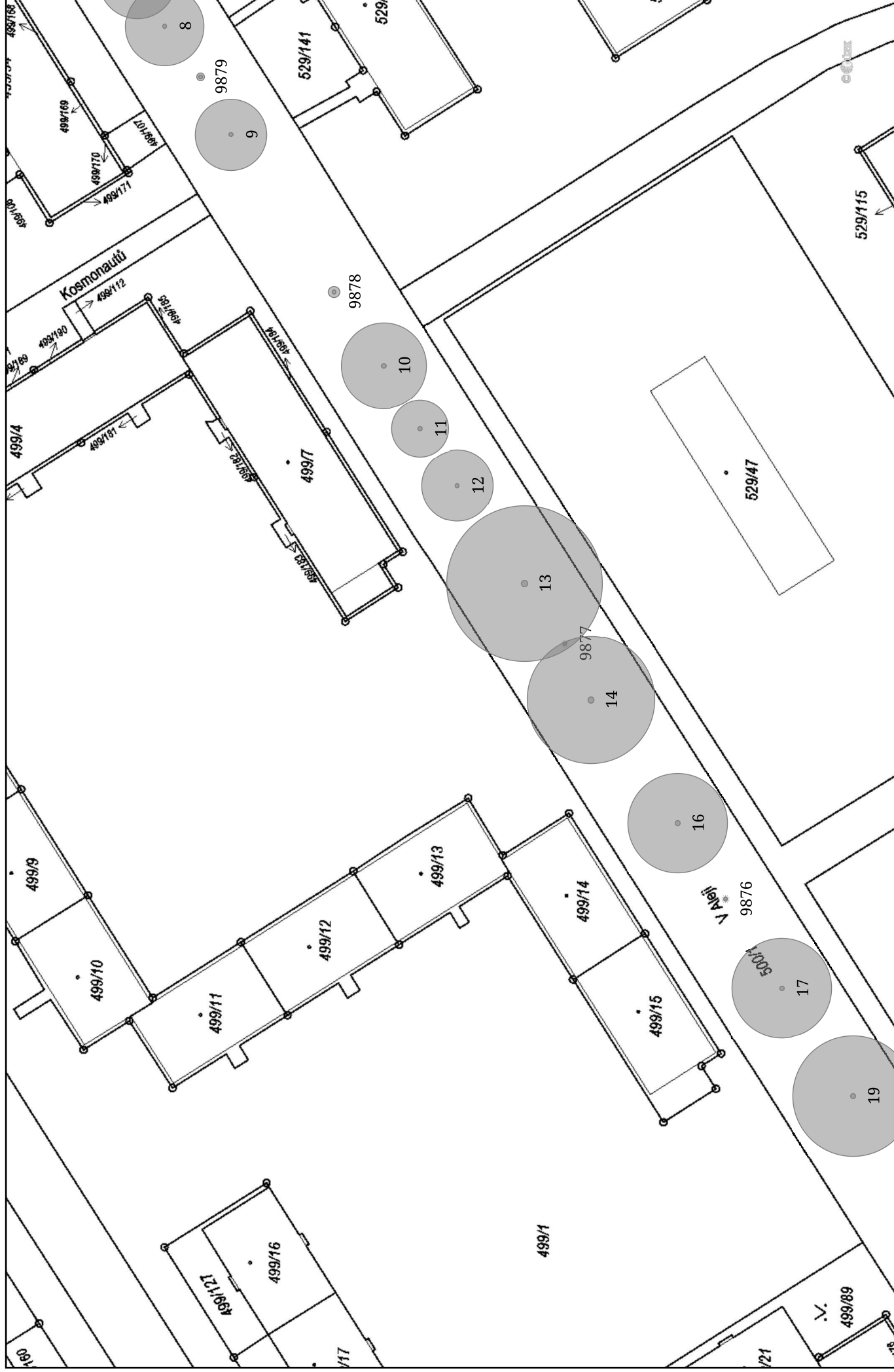

V Aleji(1:700), 3/5

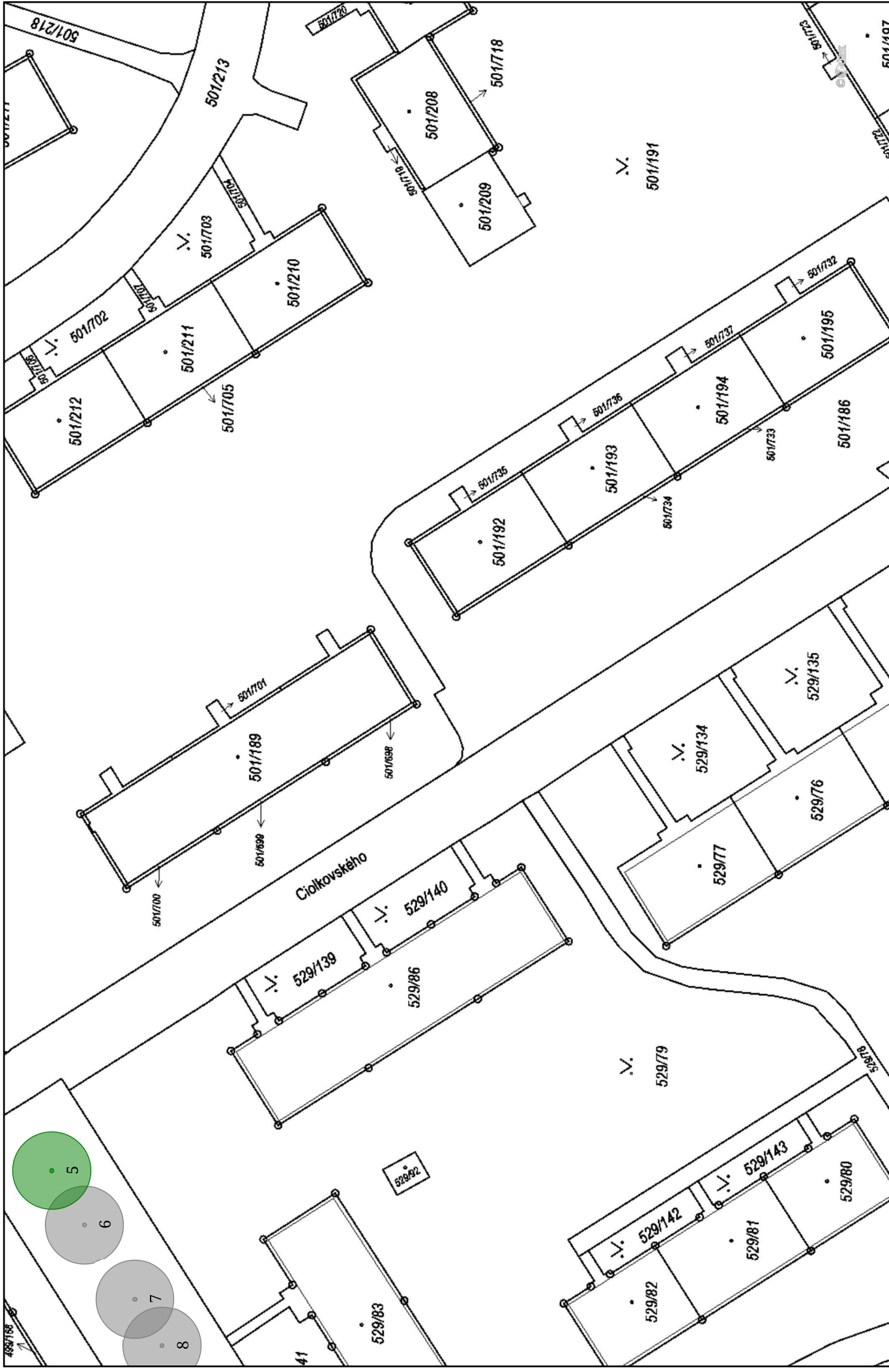

V Aleji(1:700), 4/5



V Aleji(1:700), 5/5

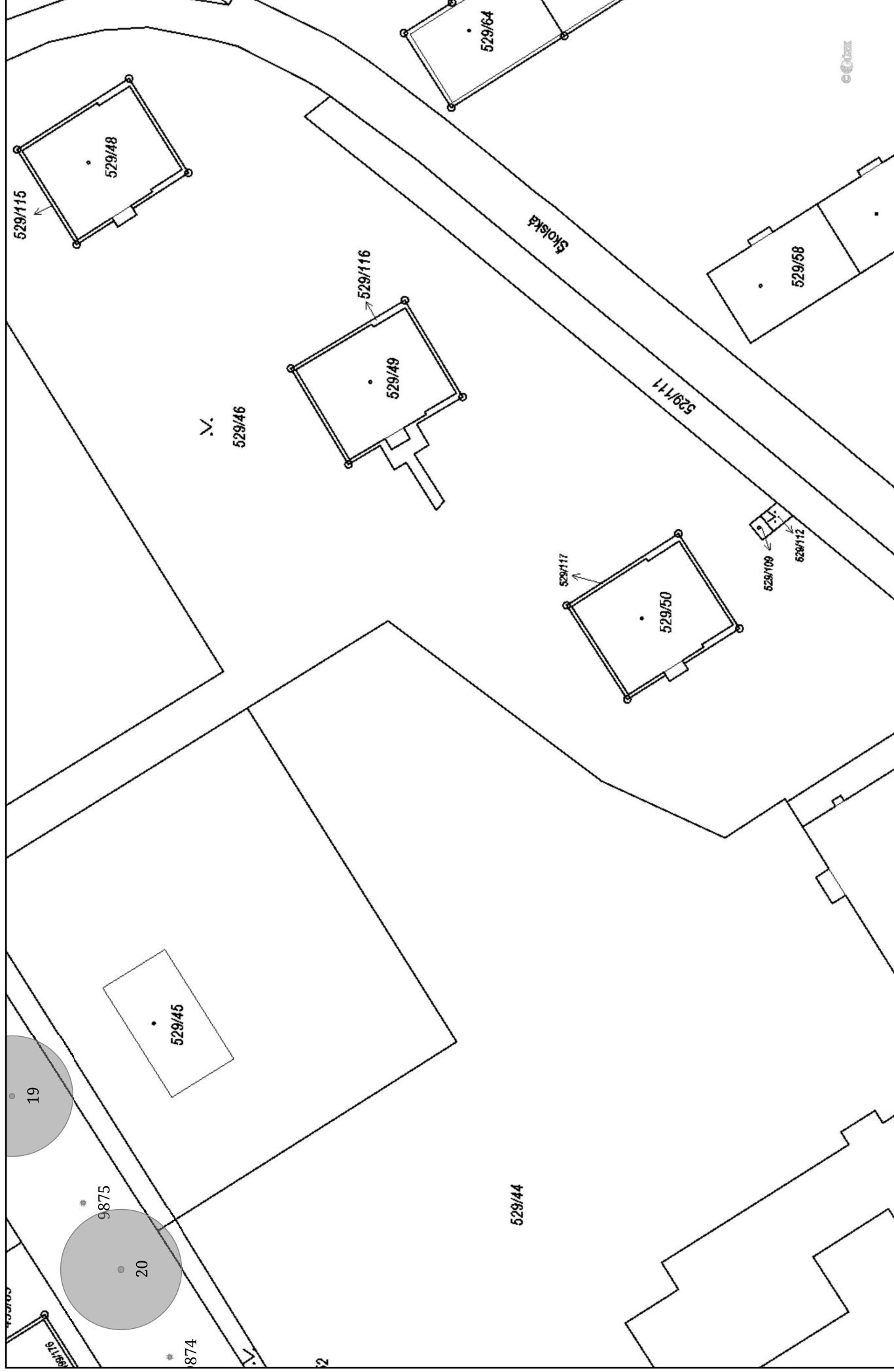

Zakladatelská - okolí(1:700) - Klad listů (1:2975)



[illegible]

Zakladatel'ská - okolí(1:700), 4/4

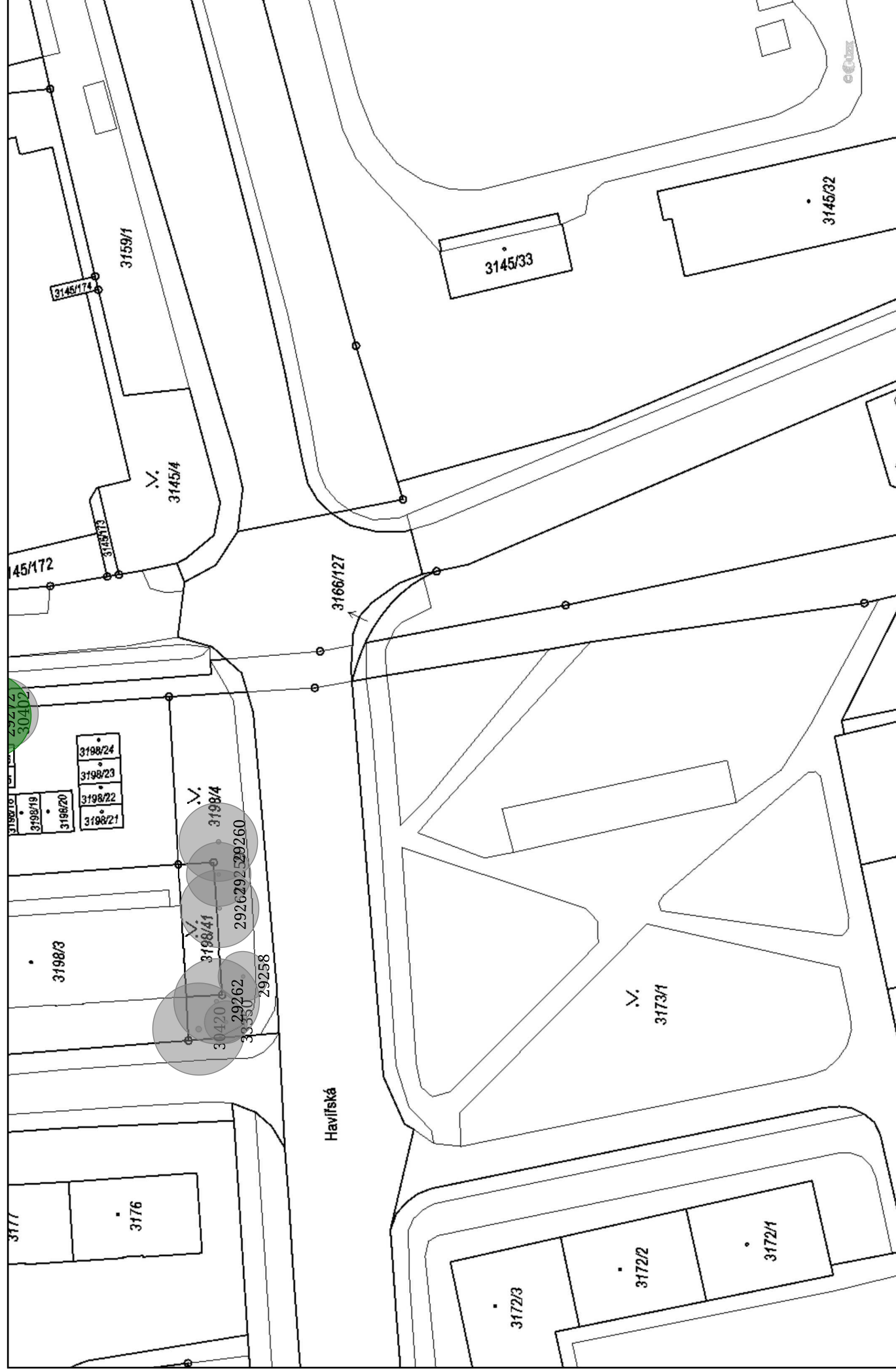

Zakladatel'ská(1:700) - Klad listů (1:3718)

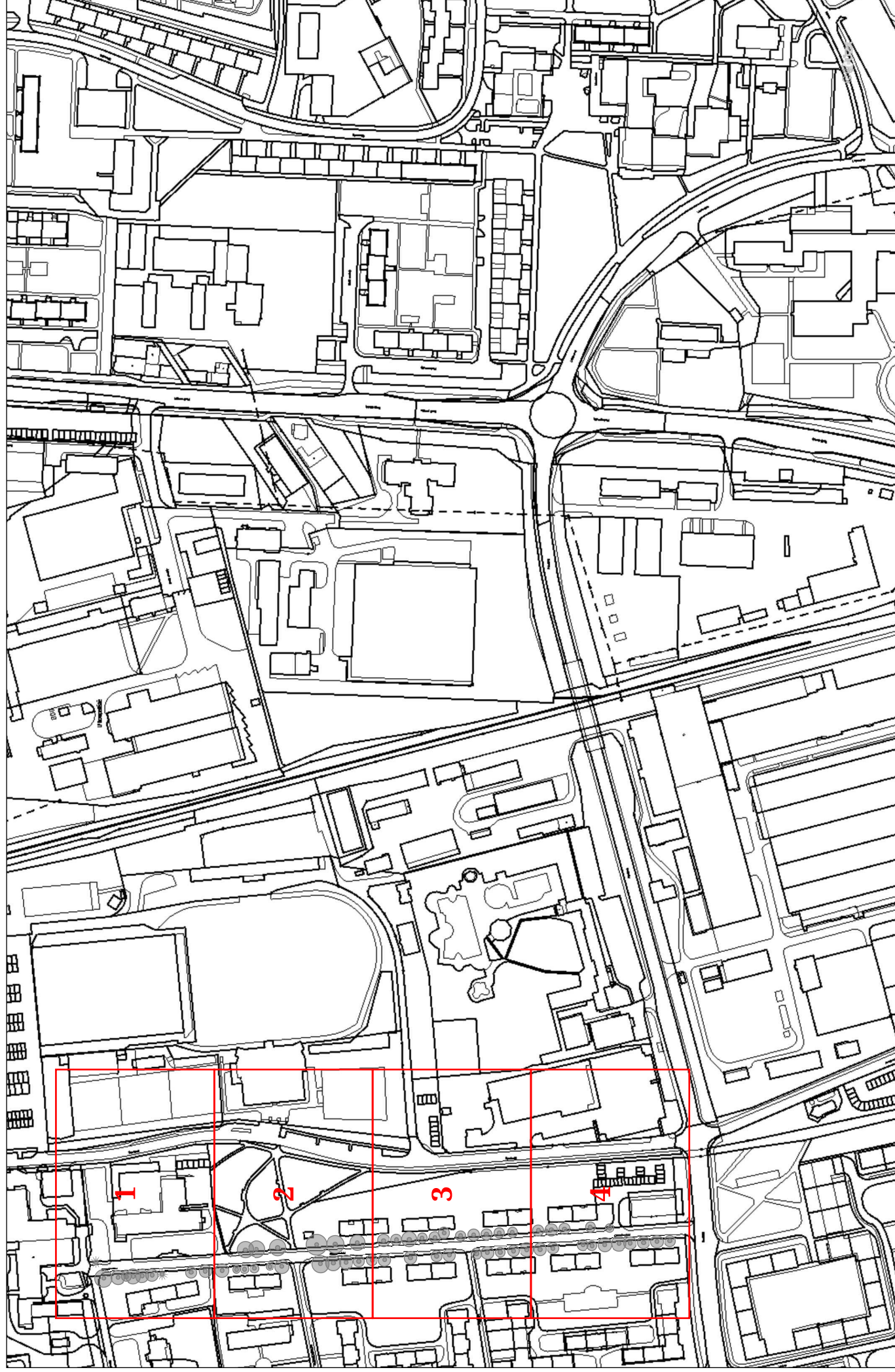

Zakladatelská(1:700), 1/4



Zakladatelská(1:700), 2/4



Zakladatelská(1:700), 3/4

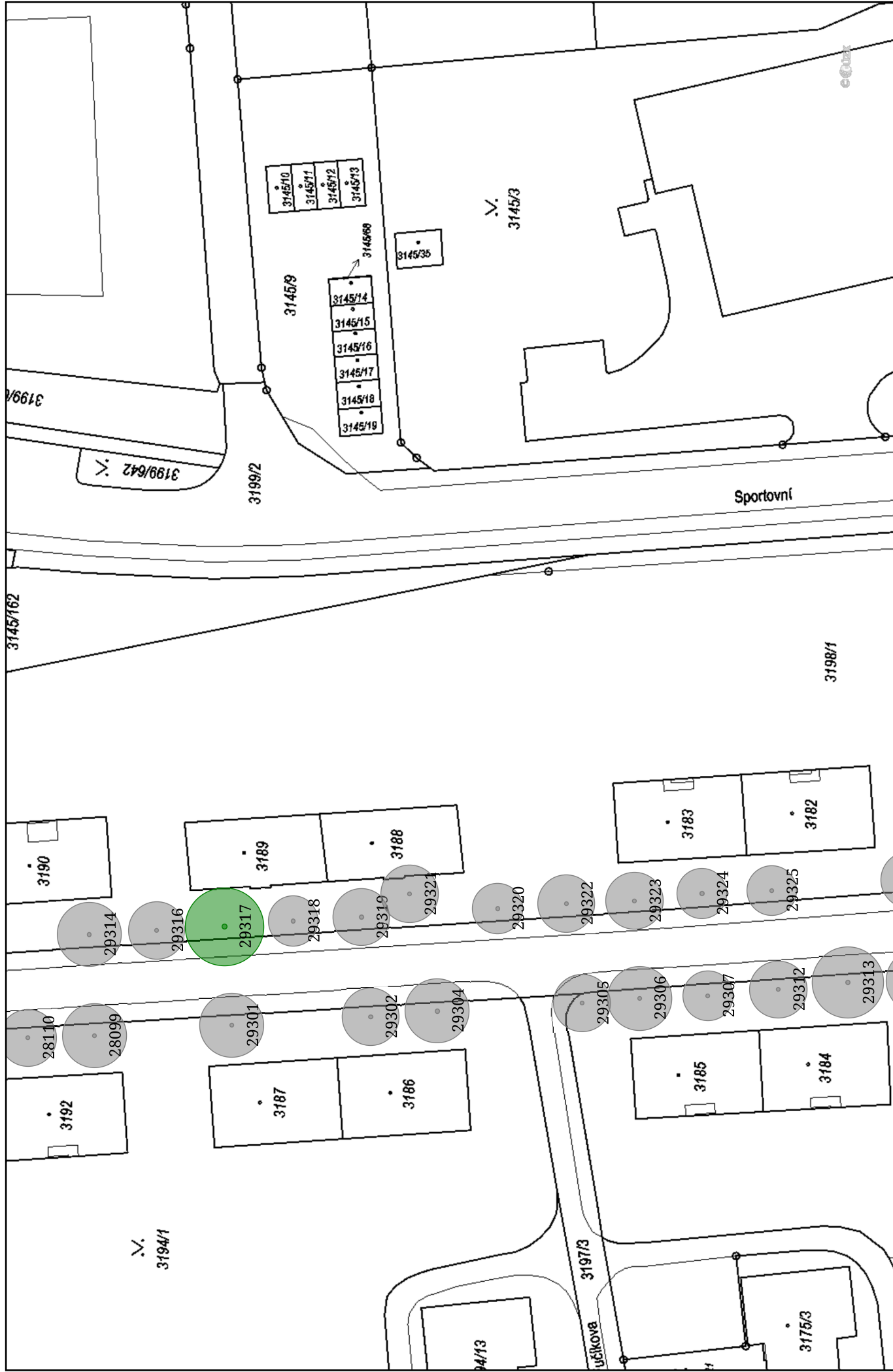

The image is a technical map of a residential area, likely a cadastral or planning map. It features a red rectangular overlay that is divided into three vertical sections, labeled with red numbers 1, 2, and 3 from left to right. The map shows various building footprints, roads, and topographical features. In the bottom left, there is a cluster of small buildings, and in the bottom middle, there is a larger building complex. The map also includes various labels in Cyrillic and numbers, such as 'Под обору' (Pod oboru) and '1000'. The red overlay covers a significant portion of the map, indicating a specific area of interest or a project boundary.

Železnice(1:700), 1/3

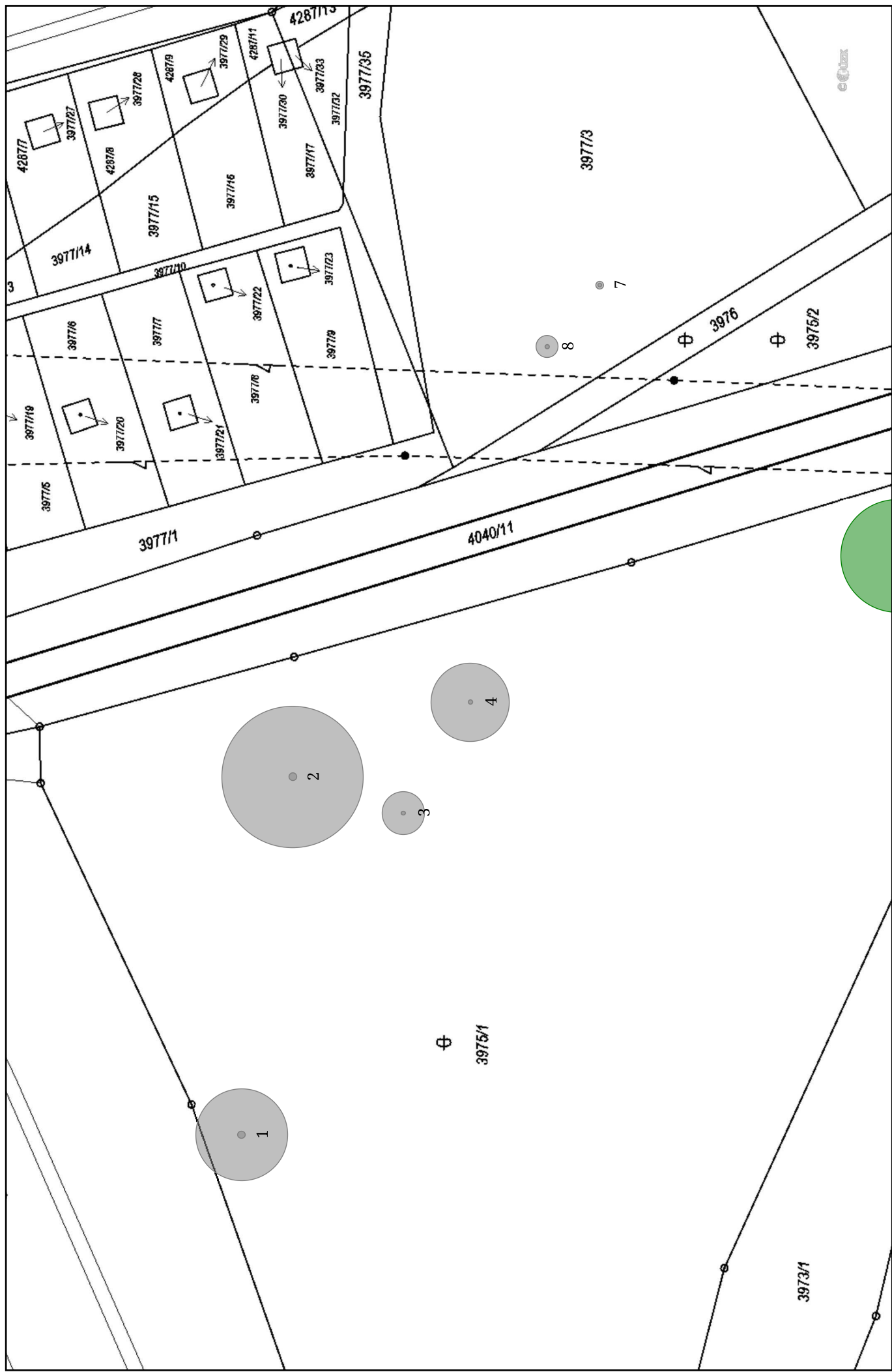

Železnice(1:700), 2/3

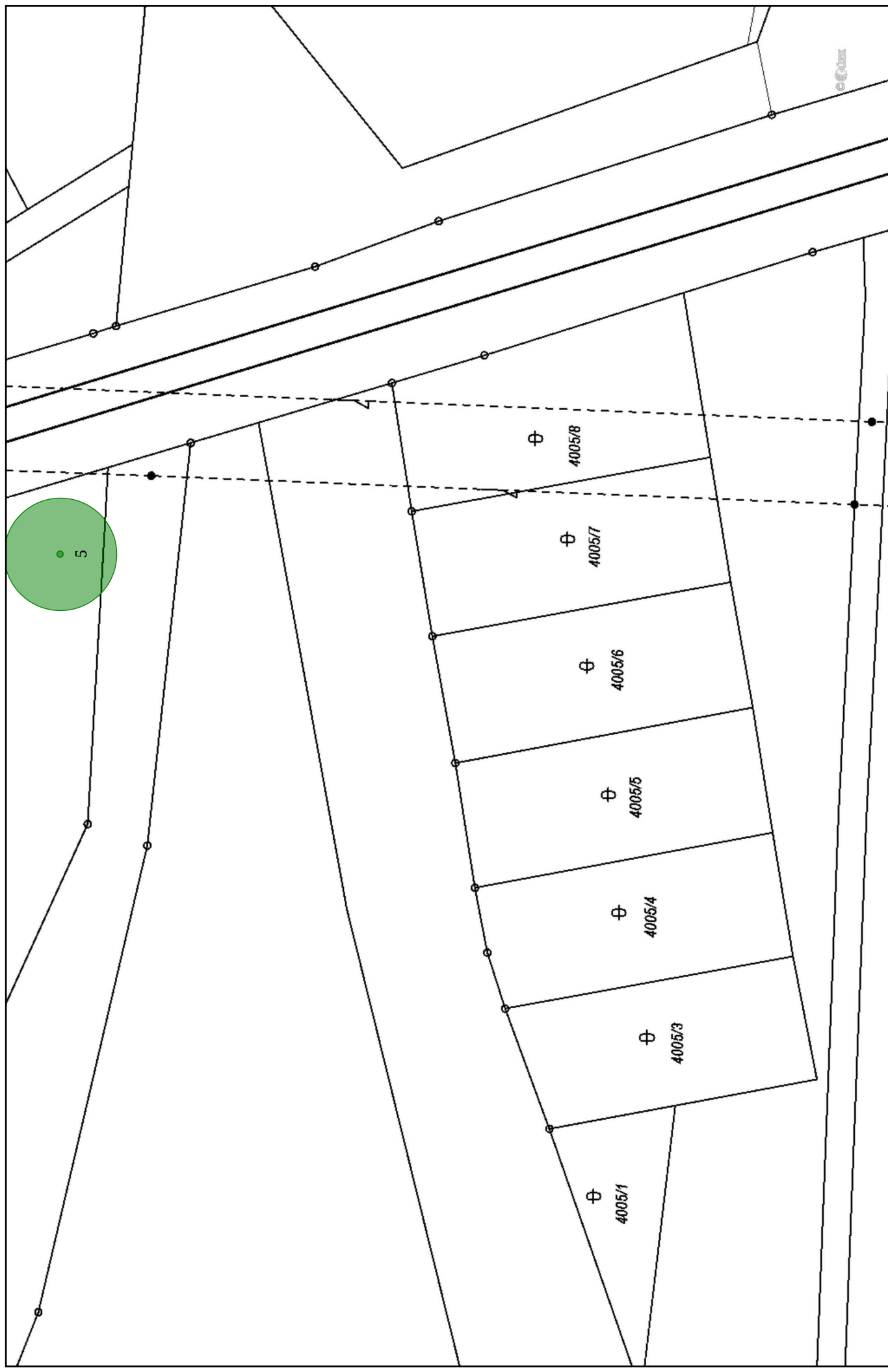

[illegible]

Žižkova x Čsl. armády x Einsteinova(1:700) - Klad listů (1:2231)

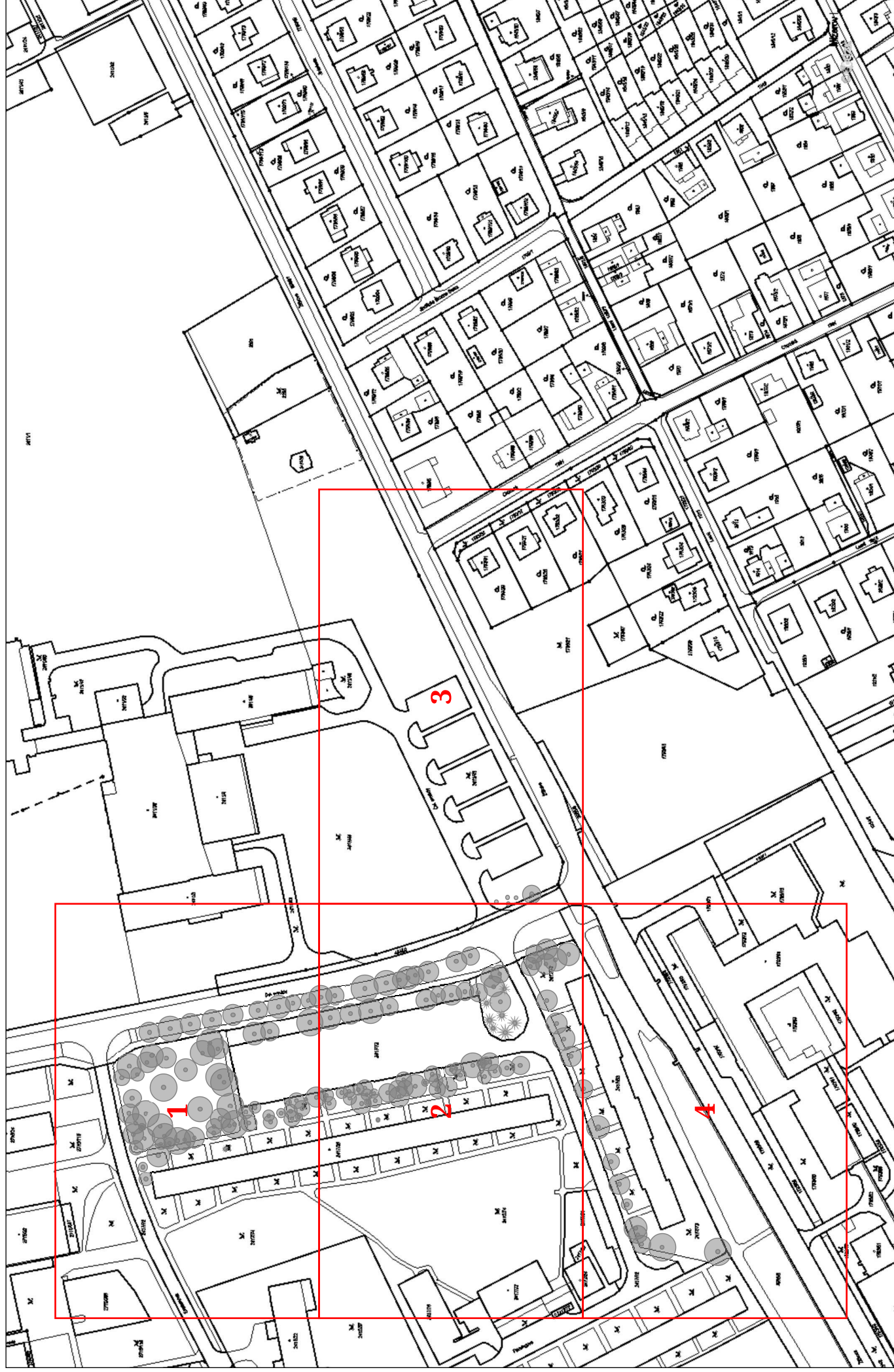

Žižkova x Čsl. armády(1:700), 1/4

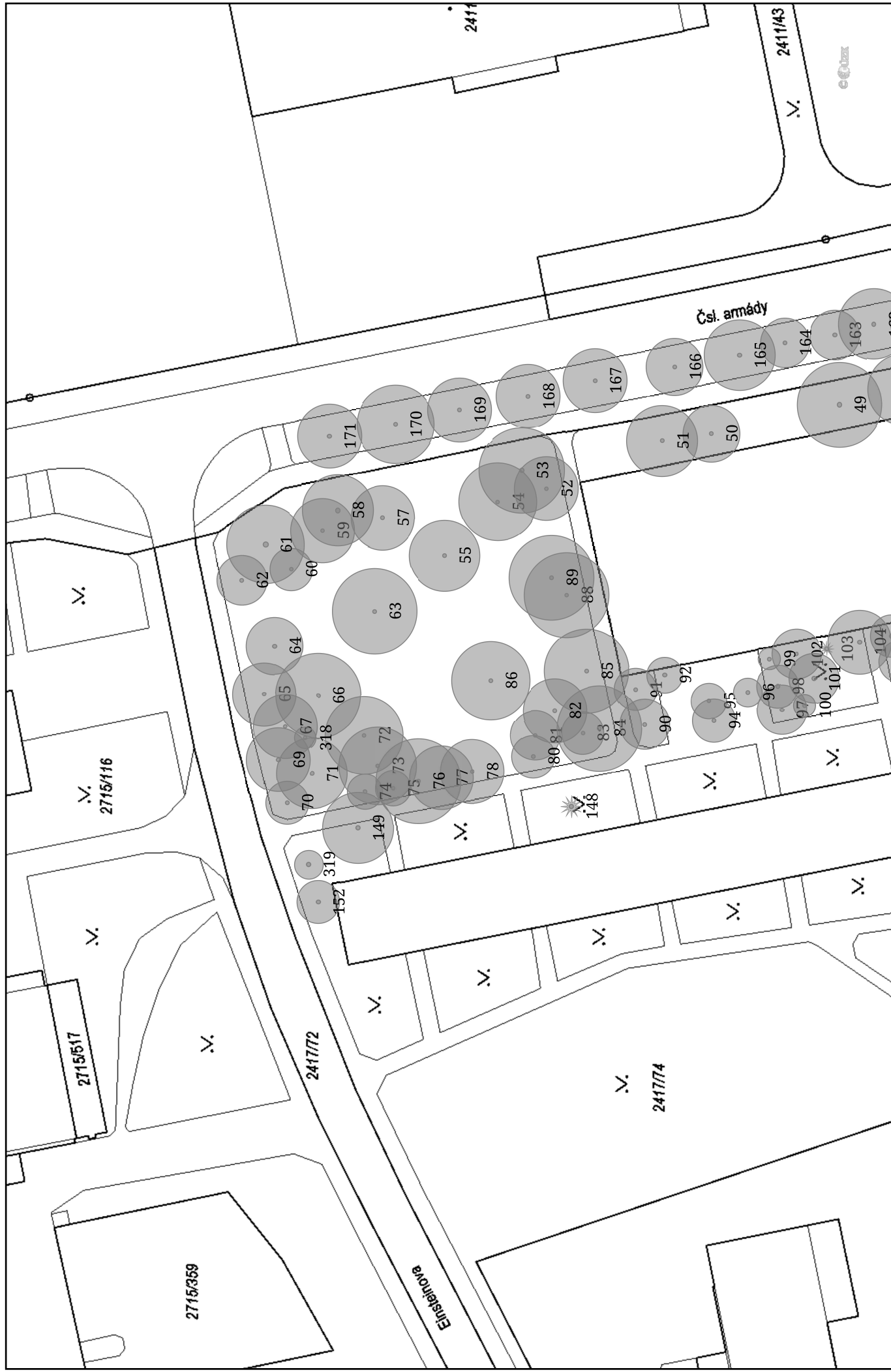

Žižkova x Čsl. armády x Einsteinova(1:700), 2/4



Žižkova x Čsl. armády(1:700), 3/4

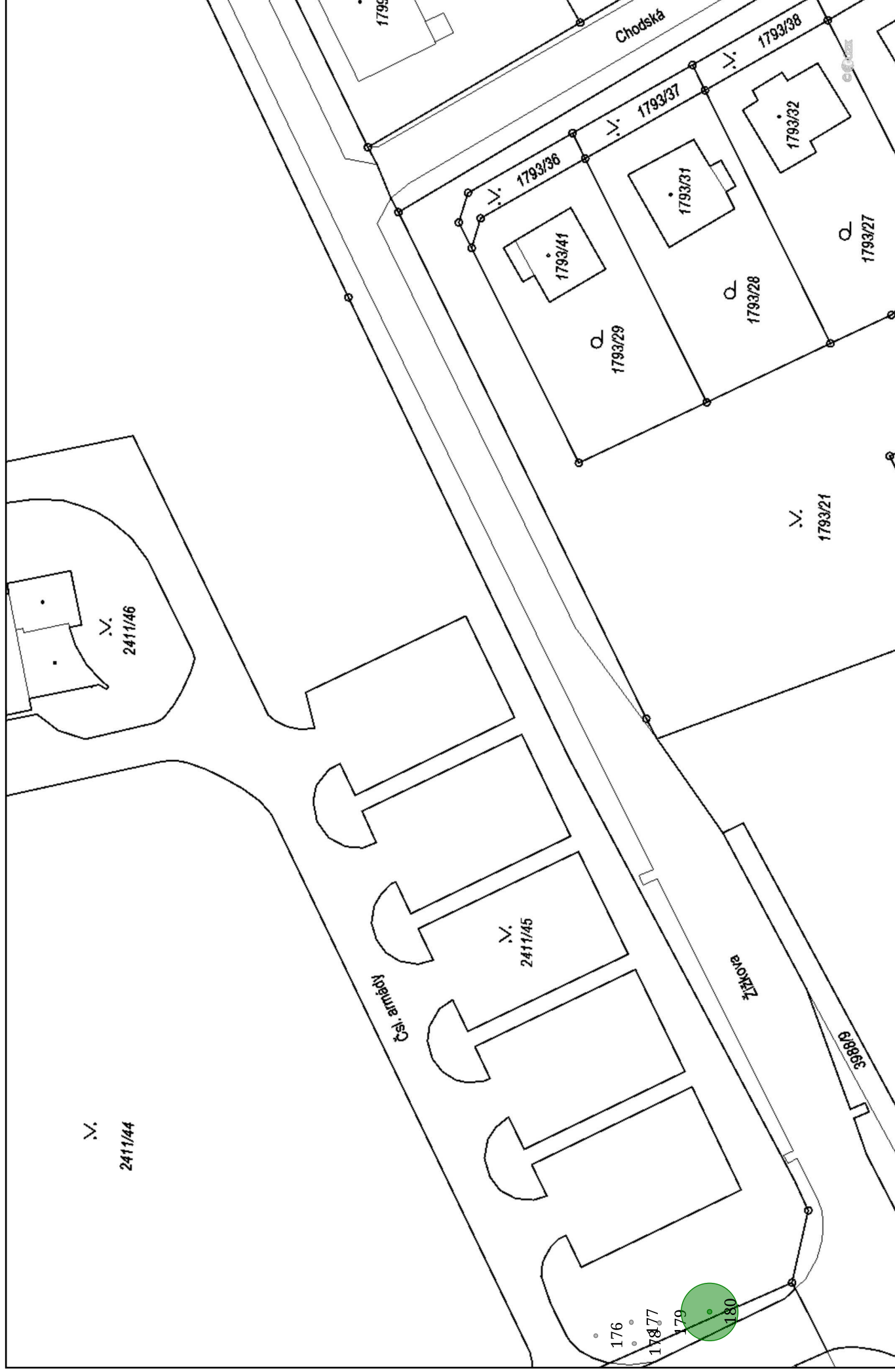

Žižkova x Čsl. armády x Einsteinova(1:700), 4/4

